



SciencesPo.

OSC
CNRS



Turun yliopisto
University of Turku

Perspectives on Contemporary Research on Educational Policy and Educational Choices and Pathways

International Seminar of CELE and KEVEKO

Paris, June 16-19, 2014

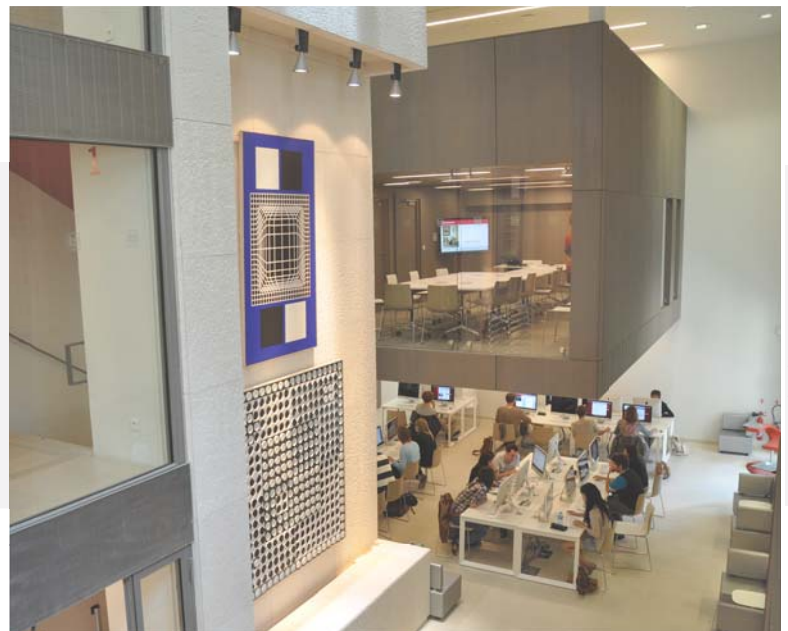

© photothèque Sciences Po

The Centre for Research on Lifelong Learning and Education (CELE) and the Doctoral Programme on Educational Policy, Lifelong Learning and Comparative Education Research (KEVEKO) from the University of Turku, Finland, organise an international seminar in Paris in June 16-19, 2014, together with their visiting professor Agnès van Zanten from the Observatoire Sociologique du Changement at Sciences Po, Paris. The seminar gathers together doctoral students and leading scholars from both France and Finland.